



3 PIECE FORGED BALL VALVE

Series 3

3 PIECE FORGED BALL VALVE

Series 3



Our C&C branded 3-piece forged ball valve is a versatile product capable of use in a wide range of applications. Our standard construction is A350 LF2 body/end cap with A182 316 stainless steel ball and stem. All valves are compliant to NACE MR0175, as well as fire-safe tested to API 607. All socket weld end connections bear heat dissipation rings which assist in deflecting heat away from the weld site, helping prevent damage to soft goods and ensure longevity of the valve.

SPECIFICATIONS

- Sizes: 0.5" - 2"
- Pressure Ratings:
 - 3,000 and 6,000 psi
- Full and reduced bore
- End Connections:
 - SW x SW, NPT x NPT, SW x NPT
- Heat dissipation rings
- Blowout proof stem
- Anti-static design
- Lockable handle
- Self-adjusting packing

STANDARDS

- Design: ASME B16.34 / ASME B31.3
- Inspection & Testing: API 598
- Design Temperature:
 - LF2: -50°F to 392°F (-46°C to 200°C)
 - A105: -20°F to 392°F (-29°C to 200°C)
 - 316SS: -50°F to 392°F (-46°C to 200°C)
- Fire Safe Tested: API 607, 5th Edition
- Socket Weld Ends per ASME B16.11
- Threaded Ends per ASME B1.20.1
- NACE MR 0175/ISO 15156-1 Compliant

Materials of Construction

Item	Part Name	Material
1	Body	A350 LF2 Cl.1
2	End Caps	A350 LF2 Cl.1
3	Ball	A182 F316
4	Seats	PEEK
5	Stem	A564 17-4PH
6	Body O-Rings	Viton GLT
7	Body Gaskets	Graphite
8	Stem Thrust Washer	PEEK
9	Stem O-Ring	Viton GLT
10	Packing	Graphite
11	Packing Gland	A276 304
12	Belleville Washer	A240 301
13	Lockhole Flange	A350 LF2 Cl.1
14	Cap Screws	A320 L7M
15	Handle	A216 WCB
16	Handle Nut	A2-70
17	Spring (anti-static)	SS316

* Above BOM reflects standard LF2 construction. Other material options available. Consult CNC Flow Control for a full list of material options per valve size and pressure, as components may vary according to design.

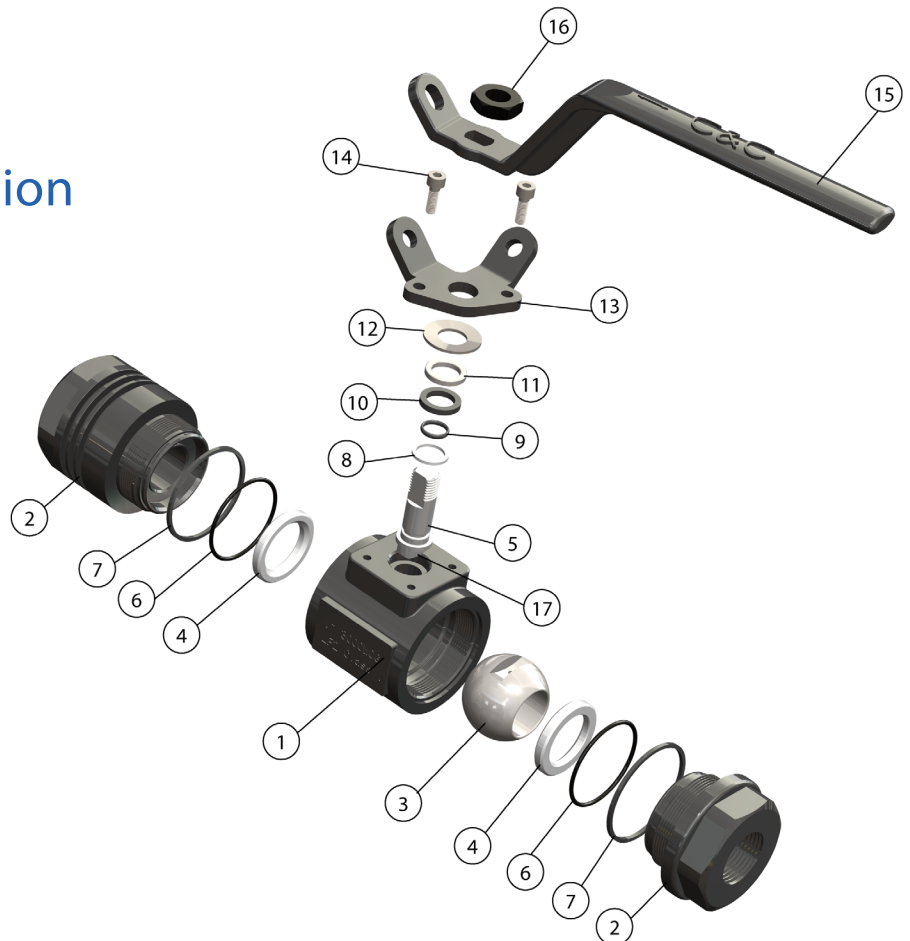

HOW TO ORDER GUIDE



EXAMPLE:

A 2" 3,000 psi 3 piece forged full port ball valve with NPT x NPT end connections, LF2 body, 316SS trim, PEEK seats, and Viton GLT seals is written as 02-BVLSVPFT-3000.

A	B	C	D	E	F	G	H	I
02	BV	L	S	P	V	F	T	3000

A	Size	
	Inches	DN
0.5	0.5"	15
0.75	0.75"	20
01	1"	25
01.5	1.5"	40
02	2"	50

B	Valve Type
BV	Ball Valve

C	Body Material	
C	Carbon Steel	ASTM A105N
L	Low Temp Carbon Steel	ASTM A350 LF2
S	Stainless Steel	ASTM A182 F316

D	Trim
S	316SS ball / 17-4PH Stem

E	Seats
P	PEEK

F	Elastomer
V	Viton® GLT
H	LT HNBR

G	Port
F	Full Port
R	Reduced Port

H	End Connection
T	NPT x NPT
B	NPT x SW
S	SW x SW

I	Pressure
3000	3,000 PSI
6000	6,000 PSI

Viton® is a registered trademark of The Chemours Company.

Weights and Dimensions

Size	Pressure Rating (psi)	Dimensions (inch)						Weight (lbs)		
		L			H	Ød1	E	SW x SW	NPT x NPT	SW x NPT
		SW x SW	NPT x NPT	SW x NPT						
0.5" (FB)	3,000	5.00	3.86	4.43	3.62	0.86	6.49	3.1	2.7	2.9
	6,000	5.67	4.37	5.02	3.66	0.86	6.49	4.2	3.5	4.0
0.75" (FB)	3,000	6.69	4.25	5.47	3.98	1.07	8.07	7.5	5.3	6.4
	6,000	6.73	4.37	5.55	4.09	1.07	8.07	8.4	5.7	7.1
1" (FB)	3,000	6.69	4.25	5.47	4.13	1.33	8.07	8.6	5.8	7.3
	6,000	6.73	5.51	6.12	4.09	1.33	8.07	11.9	9.9	11.0
1.5" (FB)	3,000	8.54	6.26	7.40	6.10	1.92	12.20	23.6	17.9	20.8
	6,000	8.54	6.26	7.40	6.14	1.92	12.20	32.2	23.1	27.8
1.5" (RB)	3,000	8.54	5.24	6.89	4.96	1.92	10.04	15.0	10.4	12.8
2" (FB)	3,000	12.75	6.30	9.53	3.97	2.41	12.20	36.0	26.7	31.3
	6,000	12.75	7.99	10.37	7.13	2.41	12.20	65.5	41.4	53.5
2" (RB)	3,000	8.54	6.26	7.40	6.10	2.41	12.20	23.2	17.4	20.3

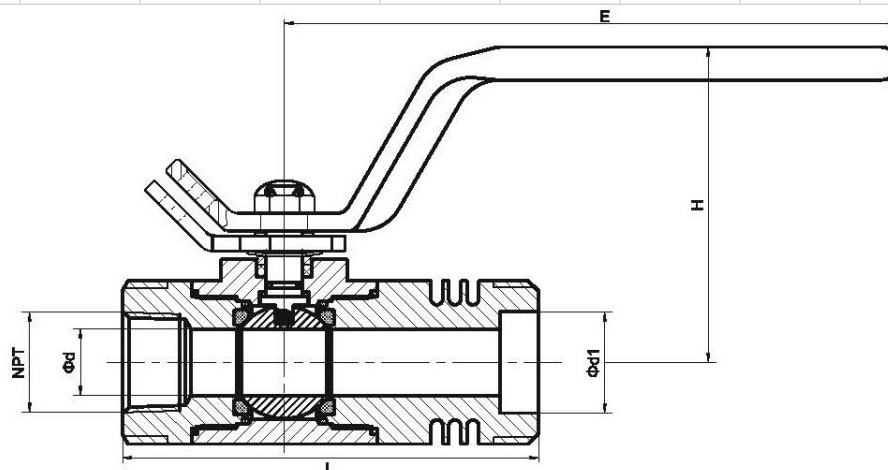

About Our Company



CNC Flow Control is headquartered in Houston, Texas with multiple other locations in the U.S. and Canada. Our company unifies several trusted valve and flow line brands that have been serving numerous industries in North America for nearly three decades. From long range projects to same-day delivery, our diverse team is dedicated to understanding customers' needs in order to ensure exceptional service and the best solutions. Our extensive product portfolio ranges from commodity products like hammer unions and needle valves, to highly engineered products like API 6D trunnion mounted ball valves.



Quality assurance is critical to CNC Flow Control's process and we hold multiple internationally recognized quality standards certifications and management system. We are dedicated to understanding our customers' needs to ensure exceptional service by offering an in-house engineering and product management team, an extremely large product portfolio and extensive inventory to support same day shipments.

Headquarters

10350 Clay Road, Suite 250
Houston, TX 77041
Toll-Free: 844.398.6449

Permian Basin

1100 W IH 20
Odessa, TX 79763
Phone: 432.276.7640

Bakken Shale

4908 Highway 85
Williston, ND 58801
Phone: 701.572.0083

Canada

2930 51 Avenue NW, Unit # 3
Edmonton, AB T6P 0E1
Phone: 780.462.9166

Website: www.cncflowcontrol.com

Follow us:



The contents of this publication are presented for informational purposes only, and while every effort has been made to ensure their accuracy, they are not to be construed as warranties or guarantees, expressed or implied, regarding the products or services described herein or their use or applicability.

© 2021 CNC Flow Control